

Southey Street

ST. WERBURGH S

APPROXIMATE FLOOR AREA
115 SQM / 1238 SQFT



GROUND FLOOR



1ST FLOOR

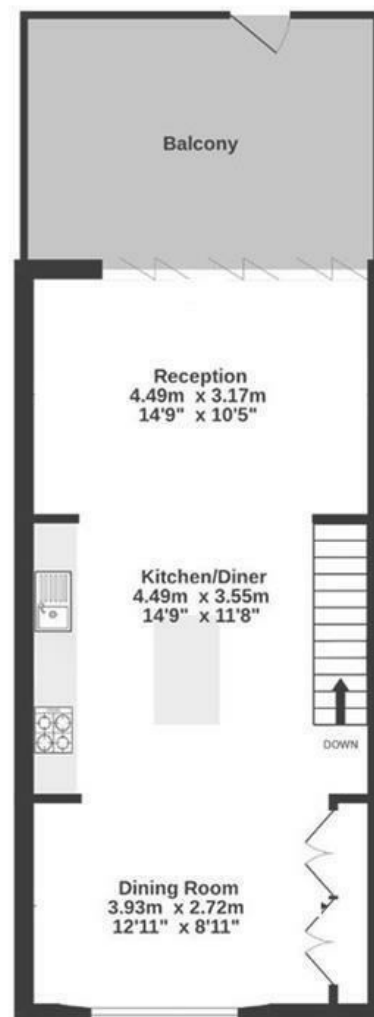

2ND FLOOR

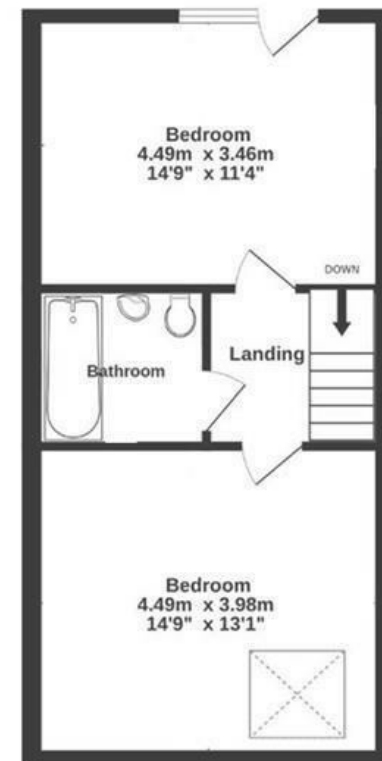

Boardwalk

Southey Street

ST WERBURGH, BRISTOL



£525,000



3 Bedrooms



BS2 9RE



2 Bathrooms

"We love our home for its bright and open design, perfect for family life. The open-plan living, dining, and kitchen area on the first floor creates a seamless flow, while the bi-fold doors lead to a sunny south-facing terrace, ideal for relaxing or entertaining. The area's strong sense of community has been wonderful for our young family. It's been a perfect first home, blending comfort, style, and neighbourhood charm."

